

Springfield Construction

Tel: 01440 821335
Mob: 07759 555178

AS12

SAAS 68

St Edmundsbury Borough Council
Planning and Engineering Services
West Suffolk House
Western Way
Bury St Edmunds
Suffolk
IP33 3YU



23rd August 2009

New Site
Submission
also Included.

Dear Sir/Madam

ON DATA-BASE

Re: Letter sent to us dated 12 August 2009. Your ref LDF.

Regarding the proposed development area opposite our property which is noted on the plan as the Naze Bungalow, (please note the bungalow has for longer than we have been here been known as Springfield).

We moved here approximately 3 years ago from the centre of Newmarket to enjoy the peace and tranquillity of Cowlinge. One of the major factors in us moving here was the fact that we can look out over open fields. Obviously we do not want to have houses on the opposite side of the road to us for this major reason. Other reasons for objecting would include the increase in noise, traffic and associated problems with having more houses around us.

In its present form as outlined on the map the area for development noted as WS17 is a definite objection from this address.

Myself and my wife are however both originally village people from Burrough Green and Brinkley respectively. We do realise unlike maybe some of the elder members of a village community (speaking generally) a village needs some growth in order to keep it alive. In Cowlinge we do not really have in our opinion a community spirit which can be found in say Burrough Green, Dullingham and similar villages. In Cowlinge the Post Office shut through lack of use, the only other community venue is the Pub which we both use but I know the pub is struggling due to the smoking ban, credit crunch etc. It would be nice to see some new blood in the village to help village amenities survive and new ones be created.

To help the village I think it needs a focal point and my proposal is as follows: Instead of Mr. Deeks applying to build along the edge of the road using minimum land for maximum gain (approximately 25% of this field) why do we not look at the whole field. Also lets look at the field behind this owned by Mr. M. Reed. Mr. Reed recently put forward a similar proposal which although was bigger had some very good points such as land for a village green and sports pavilion and children's play area etc. Again Look at the villages of Wickhambrook, Dullingham, Burrough Green etc. these villages have these amenities and are thriving compared to Cowlinge.

Springfield Construction

Tel: 01440 821335
Mob: 07759 555178

Once upon a time Cowlinge had two cricket pitches, now we have in the village cricketers playing for Stradishall, Dullingham, Burrough Green and other villages. If we had a cricket/ football/recreation ground in the village then it can only be good for the village in general as a focal point, generating revenue for local businesses and getting some community spirit going.

If these two farmers got together and developed something for the village which incorporated some amenities then I would be all in favour of more than maybe 5 or 6 houses being built. Instead of building another Kings Warren at Red Lodge type development why do we not look at developing these two fields in a village style with some houses around a village green?

I have re-designed the map you supplied with the proposed development to something which we could be enthusiastic about which in our opinion would be a bonus for the village and definitely worth backing.

Yours sincerely



Mr & Mrs. C. Phillips.

c.c. Cowlinge Parish Council.



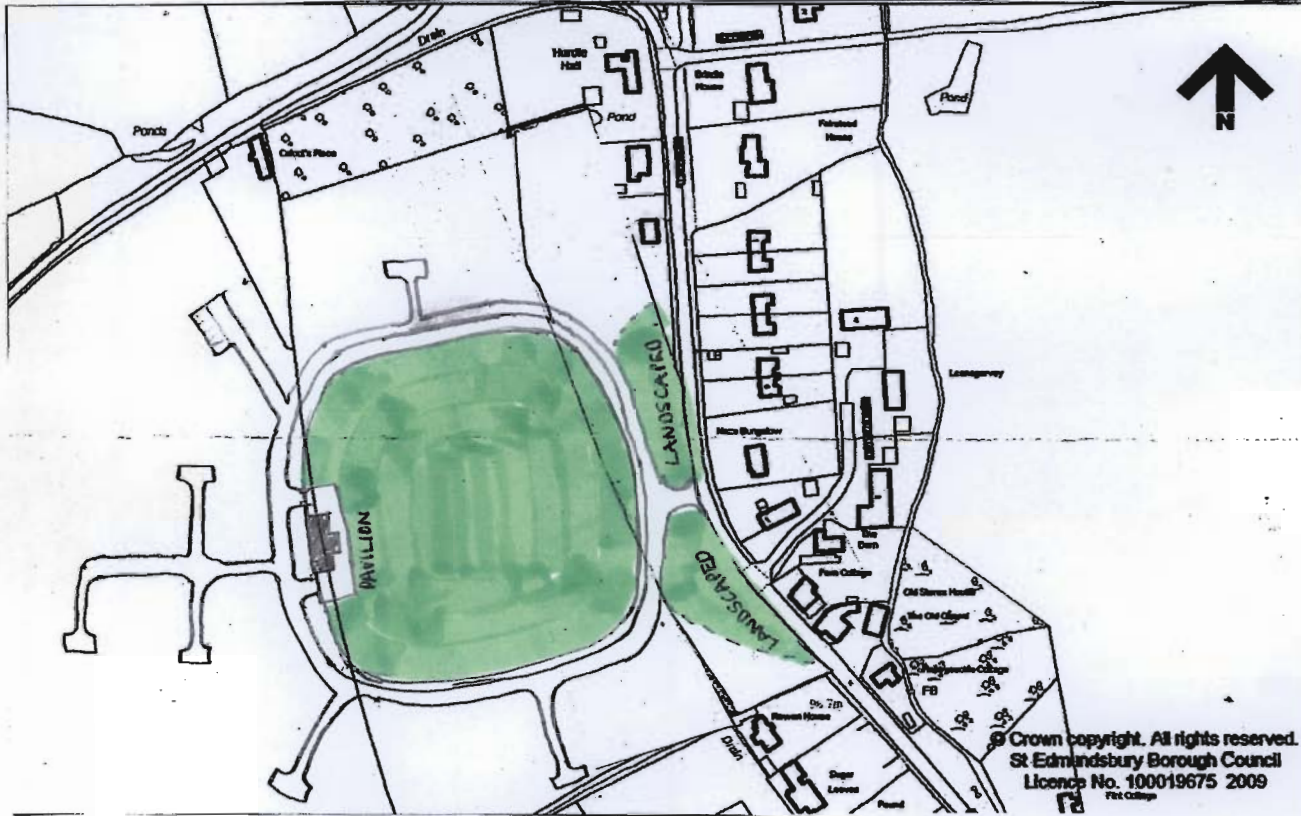

© Crown copyright. All rights reserved.
St Edmundsbury Borough Council
Licence No. 100019675 2009
Footpath