

Site Allocation Development Plan - Site Submission  
R.C.Browne & Son - Land to the North of the B1106 and A14 Interchange (Site C)

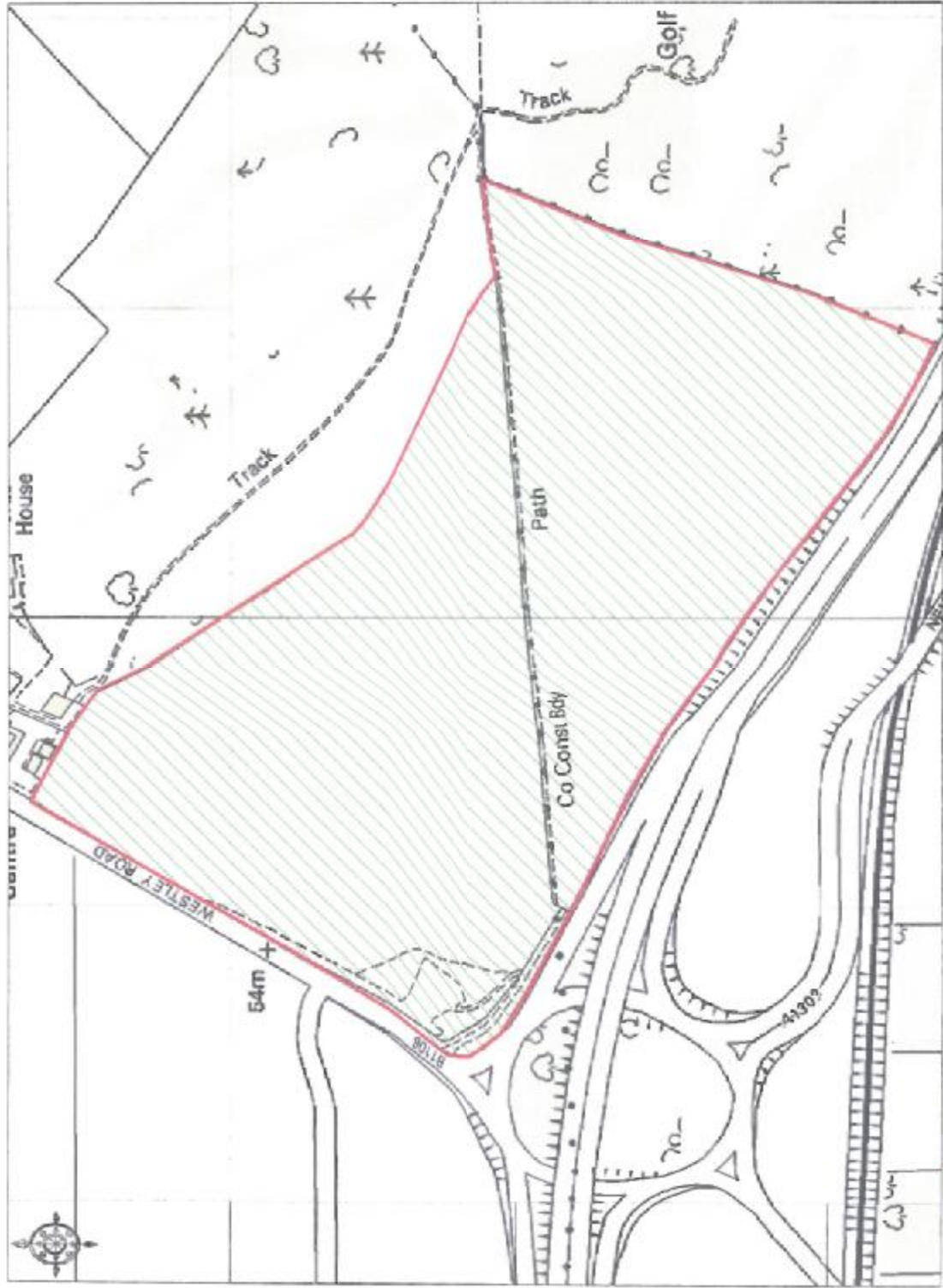

© Crown Copyright 2008. All rights reserved. Licence number 1000210. Maplet Scale - 1:5101



## 1. CONTACT DETAILS

**Your name** Peter & Charlie Browne  
**Organisation** R. C. Browne and Son  
**Address** Moseley's Farm, Fornham All Saints, Bury St Edmunds

**Postcode** IP28 6JY  
**Telephone** 01284 725603  
**Email address** rcbrowne@rcbfarms.com

**Your agents (if applicable)** N/A

**Organisation**  
**Address**

**Postcode**  
**Telephone**  
**Email address**

**Site Owner**  
**Address**

**Postcode**

Please indicate if you have the consent of the landowner to promote this site for inclusion in the Local Development Framework: Yes / No

## 2. SITE DETAILS

**Site name** Land to the North of the B1106 and A14 Interchange

**Location** North of Bury St Edmunds

**Total Area** 25.04 (ha)

Of which \_\_\_\_\_ (ha) is on brownfield land

Of which 25.04 (ha) is on greenfield land

**Ordnance Survey Grid Reference** \_\_\_\_\_

**Current use(s) (please specify last use if vacant)**

Agricultural

**Suggested uses**

Employment

## 3. DEVELOPMENT CONSTRAINTS

Is the suggested use subject to any of the following constraints?

Constraint	Yes/No	Comments
Flood Plain	No	
Nature designation	No	
Land contamination	No	
Conservation Area	No	
Special Landscape Area	No	

How close is the nearest bus stop?	1,012 metres Bus service numbers 314, 311, 905, 312.
How close is the nearest primary school?	1,761 metres
How close is the nearest shop that will provide day-to-day food needs?	2,135 metres
How close is the nearest doctor's surgery?	2.04 kilometres





## St Edmundsbury Local Development Framework

### Site Allocations Development Plan Document

#### SITE SUBMISSION SUSTAINABILITY APPRAISAL

	SA Objective	Please indicate whether your proposal will have a positive or negative contribution towards each objective
1	To improve the health of the population overall	Positive
2	To maintain and improve levels of education and skills in the population overall	"
3	To reduce crime and anti-social activity	"
4	To reduce poverty and social exclusion	"
5	To improve access to key services for all sectors of the population	"
6	To offer everybody the opportunity for rewarding and satisfying employment	"
7	To meet the housing requirements of the whole community	"
8	To improve the quality of where people live and to encourage community participation	"
9	To improve water and air quality	"
10	To conserve soil resources and quality	"
11	To use water and mineral resources efficiently, and re-use and recycle where possible	"
12	To reduce waste	"

	<b>SA Objective</b>	<b>Please indicate whether your proposal will have a positive or negative contribution towards each objective</b>
13	To reduce the effects of traffic on the environment	Y
14	To reduce contributions to climate change	Y
15	To reduce vulnerability to climatic events	Y
16	To conserve and enhance biodiversity	N
17	To conserve and where appropriate enhance areas of historical and archaeological importance	Y
18	To conserve and enhance the quality and local distinctiveness of landscapes and townscapes	Y
19	To achieve sustainable levels of prosperity and economic growth throughout the plan area	Y
20	To revitalise town centres	Y
21	To encourage efficient patterns of movement in support of economic growth	Y
22	To encourage and accommodate both indigenous and inward investment	Y