

COSTA COFFEE
BURY ST EDMUNDS, SUFFOLK BP, DT
ORACLE NUMBER: TBC
DRIVE-THRU

SCHEMATIC DRAWING PACKAGE
SOW LANE, BURY ST EDMUNDS, SUFFOLK, NORTH WEST. POSTCODE TBC.

STORE OF THE FUTURE DESIGN V1.9

SEA JOB NUMBER // 218121

- CONTENTS:
- 218121/SC01/1.0

218121/SC01/2.0

218121/SC01/3.0

218121/SC01/4.0
- PROJECT INFORMATION

- SITE PLAN: P3

- PROPOSED GENERAL LAYOUT

- CDM

| DRAWING PACK REVISION | |
|-----------------------|------------|
| REVISION | ISSUE DATE |
| 1ST | 07.12.21 |

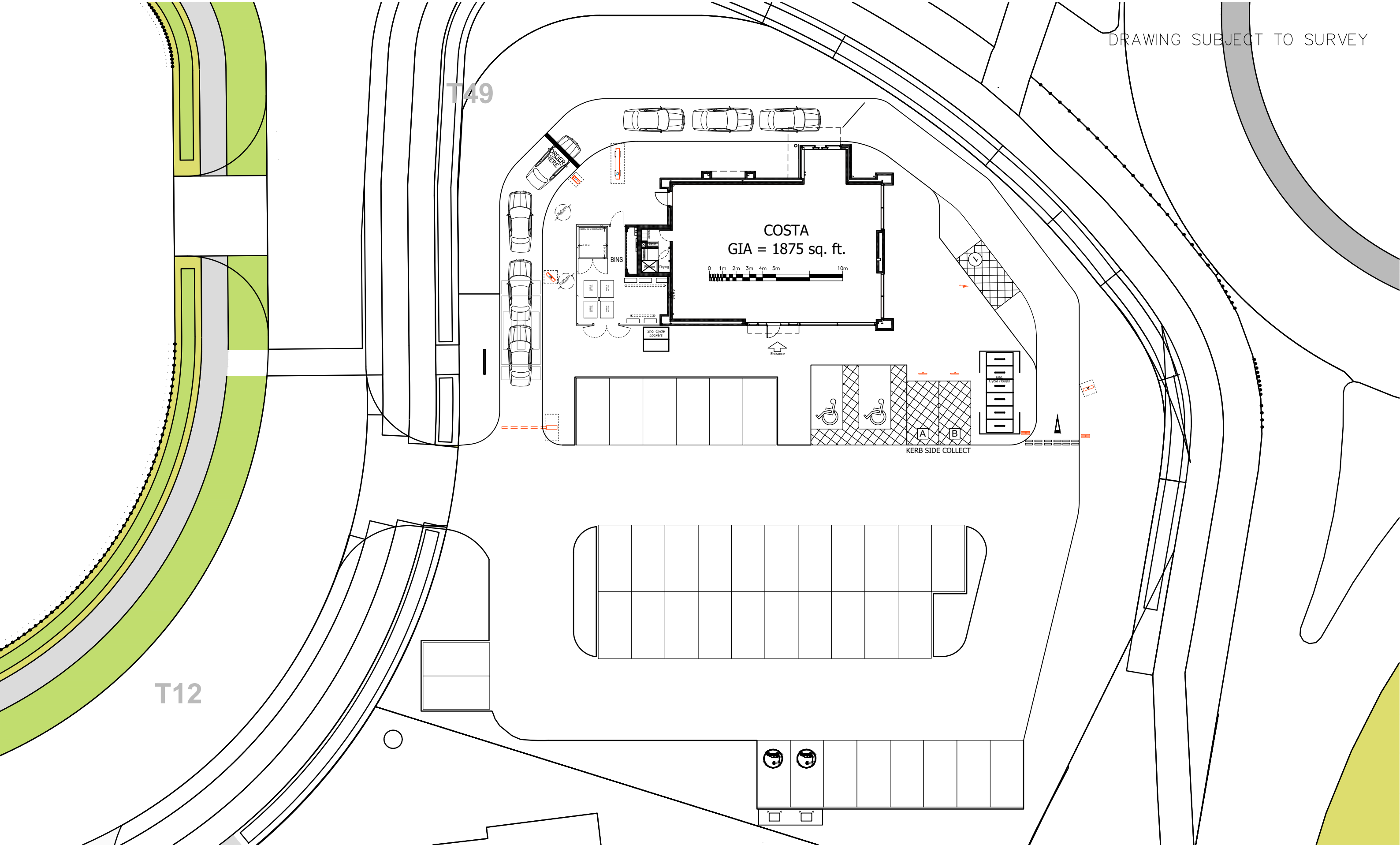

T12

T49

COSTA
GIA = 1875 sq. ft.

0 1m 2m 3m 4m 5m 10m

KERB SIDE COLLECT

PROPOSED COSTA COFFEE – BURY ST EDMUNDS
SITE LAYOUT 1:250@A3



COSTA
COFFEE
DRIVE THRU

| COVERS | | AREAS SQ M & SQ FT | | | |
|--------------|----|--------------------|--------------|----------------|------------|
| INTERNAL | | LOCATION | SALES AREA | BOH/VOID AREAS | WC & LOBBY |
| GROUND FLOOR | 60 | | | | |
| EXTERNAL | 24 | | | | |
| TOTAL | 84 | | | | |
| | | GROUND FLOOR | 1293.8 sq ft | 406.9 sq ft | 99.0 sq ft |
| | | | 120.2 sq m | 37.8 sq m | 9.2 sq m |
| | | EXTERNAL AREA | 399.3 sq ft | | |
| | | | 37.1 sq m | | |

| COUNTER AREA % | |
|----------------|-------|
| SQM | 28.9 |
| SQ FT | 311.0 |
| COUNTER AREA % | 23.4 |

| KEY FOR FURNITURE ZONES | |
|-------------------------|-------------|
| --- | - SHOPFRONT |
| --- | - EXPRESS |
| --- | - REFRESH |
| --- | - RELAX |

LAYOUT DRAWN FROM INFORMATION BY OTHERS
& SUBJECT TO THE FOLLOWING:
- COMPLETION OF SHELL
- FULL SITE SURVEY

COUNTER NOTE:
MAIN CONTRACTOR TO REFER TO ITAB LATEST
APPROVED COUNTER DETAILS

NOTE:
TO BE READ IN CONJUNCTION WITH LATEST DESIGN GUIDE

This drawing is the copyright of Street Elite Associates Limited. Do not scale from drawings. All dimensions and levels to be checked on site prior to commencement of work or manufacture of items. Notify SEA of any discrepancies. This drawing to be read in conjunction with specifications, specialist drawings and any bill of quantities. The Contractor is to comply with all relevant statutory legislation whether or not specifically stated on these drawings.

WALL HATCH KEY:

| |
|--------------------------------------------|
| INDICATES SHELL WALLS |
| INDICATES NEW STUD WALL WITH INSULATION |
| INDICATES NEW STUD WALL WITH NO INSULATION |
| INDICATES JUMBO STUD |
| INDICATES FIRE ESCAPE ROUTE |

DESIGN NOTES:

- Allow for counter front/ face to be Geaves, High Impact Laminate, Costa Red
- Allow for counter worktop to be HI-MACS G004 White Quartz
- Allow for suspended ceiling raft over counter with smooth plaster finish and recessed down lights
- Allow for dropped MF ceiling within DT window & down lights
- Allow for exposed ceiling throughout trade area with track lighting
- Allow for dropped MF ceiling to WC's lobby and WC's with smooth plaster finish & down lights
- Allow for new lay-in grid ceiling in Back of House & LED light tiles
- Allow for 1800 sq ft halo ring above counter ref. CTAHR-01
- Allow for feature lighting as indicated on plan, 14no proposed
- All ducting to be exposed
- All HVAC cassettes and ducting to be exposed. HVAC cassettes to be pre finished black fascias ref BYCQ140EGFB.
- For signage proposal, refer to Ashleigh Signs Signage Package

INTERNAL FURNITURE REFERENCES

| | | | | |
|-----------------------------|----------------------------|----------------------------|-----------------------------|----------------------------|
| C2 Latte Chair QTY 15 | C3 Kara Chair QTY 10 | C4 Amor Chair QTY 04 | C5 Malta Chair QTY 03 | C6 Bean Chair QTY 02 |
|-----------------------------|----------------------------|----------------------------|-----------------------------|----------------------------|

| | | | |
|-------------------------------------|---------------------------------|--------------------------------|----------------------------|
| C9 Mini Cocktail Chair QTY 16 | C10 Arma Banquette QTY 01 | C11 Cocktail Sofa QTY 01 | C16 Pop Stool QTY 01 |
|-------------------------------------|---------------------------------|--------------------------------|----------------------------|

| | | | |
|------------------------------------|----------------------------------|---------------------------------|---------------------------------|
| CT2 Coffee Table Oval QTY 01 | T1 Dining 550 x 550 QTY 17 | T2 Dining 610 dia. QTY 05 | T4 Dining 760 dia. QTY 02 |
|------------------------------------|----------------------------------|---------------------------------|---------------------------------|

| | | |
|-----------------------------------|-----------------------------------|-----------------------------------|
| MFT Mill Fixed Table QTY 06 | MFS Mill Fixed Stool QTY 12 | MFB Mill Fixed Bench QTY 06 |
|-----------------------------------|-----------------------------------|-----------------------------------|

TABLE TOP TYPE

| |
|----------------------------|
| A (T1/ T4/ T2) Light |
| B (T1/ T4/ T2) Dark |

TABLE TOP TYPE

| |
|--------------------------|
| A (CT1/ CT2) Stone |
|--------------------------|

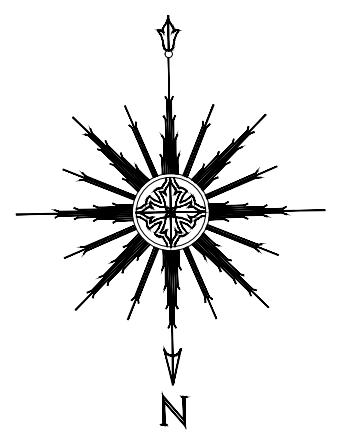

FEATURE PENDANT REFERENCES

LP08 - FEATURE PENDANT
COLOUR: Coffee glass with brass lamp holder and burgundy flex
BULB: LED filament squirrel cage, E27, 4W, 350lm (sold separately)
DIMENSIONS: 180mm H x 180mm dia.
FLEX LENGTH: 2000mm

QUANTITIES

LP09 - FEATURE PENDANT
COLOUR: Coffee glass with brass lamp holder and burgundy flex
BULB: Tube LED E27 filament, 6W, 170lm (sold separately)
DIMENSIONS: 300mm H x 180mm dia.
FLEX LENGTH: 2000mm

QUANTITIES

| CLUSTER QUANTITIES | |
|--------------------|----|
| LP08/09-CL3 | 03 |

LP10 - FEATURE PENDANT
COLOUR: Brass cage with wood top and burgundy flex
BULB: LED filament squirrel cage, E27, 4W, 350lm (sold separately)
DIMENSIONS: 200mm H x 360mm dia.
FLEX LENGTH: 2000mm

QUANTITIES

LP35 // LED FILAMENT LAMP TO BE HUNG
WITH HANGING CUP INSTALLATION
BULB: LP05
FLEX DETAIL: 2m burgundy twisted braided flex
INSTALLATION HEIGHT: 1850mm AFFL to underside
of the lowest cup, 2000mm to underside of bulb

QUANTITIES

SEA DESIGN GROUP

Client
COSTA
COFFEE

Project
Bury St Edmunds, Suffolk BP, DT

Drawing Title
Proposed General Layout

Schema
SOTF

Scale
1:50@A1

Date
13.08.19

Drg No
218121/SC01/3.0

Rev
A

Drg By
YS

Check
SV

Revisions By
A: Updated to include latest site plan, shower room and to latest model CW 07.12.21

SEA DESIGN GROUP Unit 13D Princess Drive, Kenilworth, Warwickshire, CV8 2FD UK
Email sea.uk@seadesigngroup.com Telephone +44 (0)1926 864440

NOTE:
TO BE READ IN CONJUNCTION WITH LATEST DESIGN GUIDE

This drawing is the copyright of Street Eite Associates Limited. Do not scale from drawings. All dimensions and levels to be checked on site prior to commencement of work or manufacture of items. Notify SEA of any discrepancies. This drawing to be read in conjunction with specifications, specialist drawings and any bill of quantities. The Contractor is to comply with all relevant statutory legislation whether or not specifically stated on these drawings.

EATING AREA

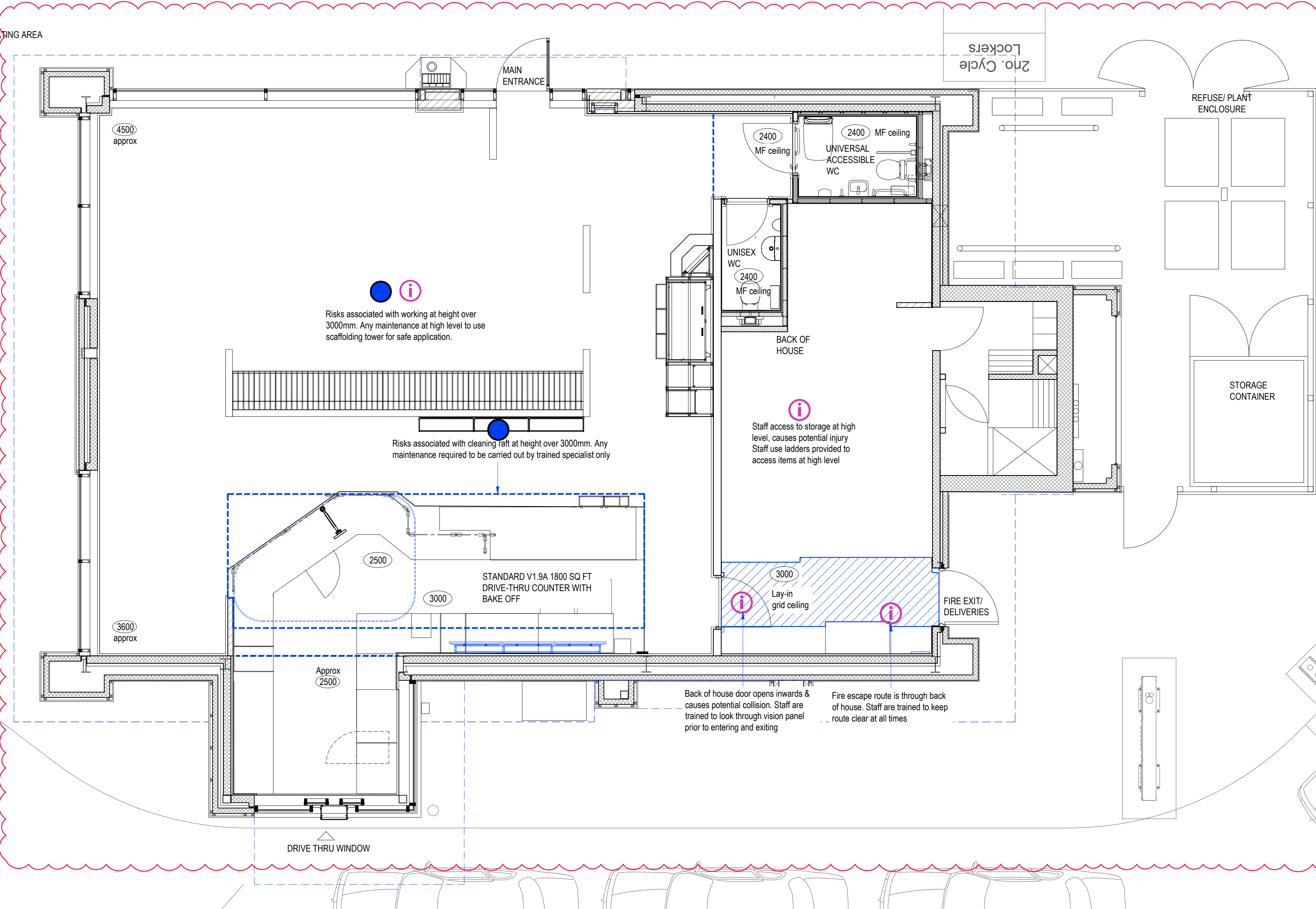

| RISK | LEVEL OF RISK | | | ACTIONS TAKEN TO REDUCE / REMOVE RISK | RESIDUAL RISK | | | ACTIONS TAKEN TO REDUCE / REMOVE RISK | COMPLETED BY | DATE |
|--------------------------------------------------------------------------------------------------------------------------------------------------------------------------------|---------------|---|---|-------------------------------------------------------------------------------------------------------------------------|---------------|---|---|------------------------------------------------------------------------------------------------------------------------------------------------------------------------------------------------------------------------------------------------------------------------------------------------------------------|--------------|----------|
| | L | M | H | | L | M | H | | | |
| Site Works There are no works nor materials used that are abnormal for this type of Project that a competent Contractor should be aware of (to be reviewed on each project) | | | | | | | | | | |
| Full height glazed shopfront, causes potential collision hazard | | M | | Manifestation are to be applied to glazing, to avoid collision | L | | | N/A | CW | 01.12.21 |
| Main entrance door opens outwards, into pedestrian walkway, causes potential collision hazard | | M | | 950mm high s/s barrier to be installed to avoid collision | L | | | N/A | CW | 01.12.21 |
| Universal Accessible WC door opens outwards, causing potential collision hazard | | M | | Door opens outwards against wall to avoid collision. Door closure fitted & sufficient space for disabled turning circle | L | | | N/A | CW | 01.12.21 |
| Staff access to storage at high level, causes potential injury | | | H | Suitable ladders to be provided for works upto 3000mm | L | | | Staff use ladders provided to access items at high level | CW | 01.12.21 |
| Back of house door opens inwards & causes potential collision | | M | | Provide vision panel to avoid collision | L | | | Staff are trained to look through vision panel prior to entering and exiting | CW | 01.12.21 |
| Ceiling height over 3000mm | | M | | LED Lamps installed to minimise maintenance | L | | | Any maintenance required to be carried out by trained specialist | CW | 01.12.21 |
| Risks associated with working at height over 3000mm | | | H | Scaffolding tower to be used for all works above 3000mm | L | | | Any maintenance works required, scaffolding tower to be used | CW | 01.12.21 |
| Risks associated with cleaning raft at height over 3000mm | | | H | Raft to be cleaned/maintained by specialists with the use of the appropriate and safe equipment | L | | | Any maintenance required to be carried out by trained specialist only | CW | 01.12.21 |
| Risks associated with internally cleaning DT window above counter height | | | H | Works to be completed by a competent window cleaner using appropriate equipment to clean the window | L | | | N/A | CW | 01.12.21 |
| Fire escape route is through back of house | | M | | Route is demarked by high contrast safety flooring to ensure identifiable | L | | | Staff are trained to keep route clear at all times | CW | 01.12.21 |
| Movement of heavy equipment causes potential risk | | | H | All procedures to be carried out in line with main contractor risk assessment | L | | | N/A | CW | 01.12.21 |
| Materials that could cause harm to health both during construction and post construction | | | H | No specified materials have any notable effect on health either during construction or residual | | M | | Contractor to implement methods to reduce harm to operative's health during construction. Processes to be highlighted within CPP and RAMS and wherever possible to use mechanical aid/extraction equipment. Contractor to refer to design risk information and drawings for highlighted notes and consider COSHH | CW | 01.12.21 |
| Traffic movements & access to and from within the store, including the need for reversing. Construction traffic in close proximity to public areas | | | H | Acess for delivery via BOH door. Site is a DT with sufficient parking spaces & circulation space | | M | | Traffic management arrangements to be discussed between the PC & site/landlord/ centre management prior to SOS. Any special arrangements/ process documented within the site specific small works plan | CW | 01.12.21 |

What is the level of risk

H - High Risk - High risk of accident or injury

M - Medium Risk - Reasonable risk of Accident or injury

L - Low Risk - Seldom or no risk of accident or injury

Actions to be taken

H- Risk to be designed out

M- Risk to be designed out or a plan of protection to be proposed

L- Risk to be identified as potential and identified

FINAL PACK CHECKED BY

SJ

07.12.21

NOTES:

1. SEA as a designer, has not identified any significant or unusual risks associated with the design or the site which a competent contractor would not be expected to be aware of and able to manage effectively.

2. Asbestos may be present in the fabric of the building and at risk of being disturbed during the works. Any intrusive works should not commence on site until the Principal Contractor/Contractor is in possession of an up to date Refurbishment & Demolition Asbestos Survey report for the store/areas affected by the works, and has read and understood the survey report.

CDM SYMBOLS - REFER TO DESIGNER RISK ASSESSMENT



Used to warn of significant design risks and site hazards



Used to avoid or prevent a particular action



Used to encourage a particular action



Used to convey some relevant CDM information

0 1M 2M 3M 4M 5M 10M

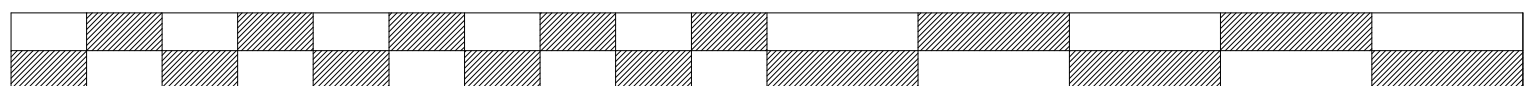

SCALE BAR SCALE 1:50

SEA DESIGN GROUP

Client

COSTA
COFFEE

Project

Bury St Edmunds, Suffolk BP, DT

Drawing Title

CDM

Scheme

SOTF

Scale

1:50@A1

Date

13.08.19

Drg No

218121/SC01/4.0

Rev

A

Drg By

YS

Check

SV

Revisions

By

A: Updated to include latest site plan, shower room and to latest model CW 07.12.21